

## Manual for Login/Sign Up and using the Dashboard of Mindomo

### ○ Sign Up/ Login

Visit <https://www.mindomo.com/> to access the Mindomo ICT tool. To sign-up and create a new account on Mindomo, click on 'Sign In' in the right corner of the page, as shown in the Figure 1.



Figure 1

A page will open as showed in Figure 2.

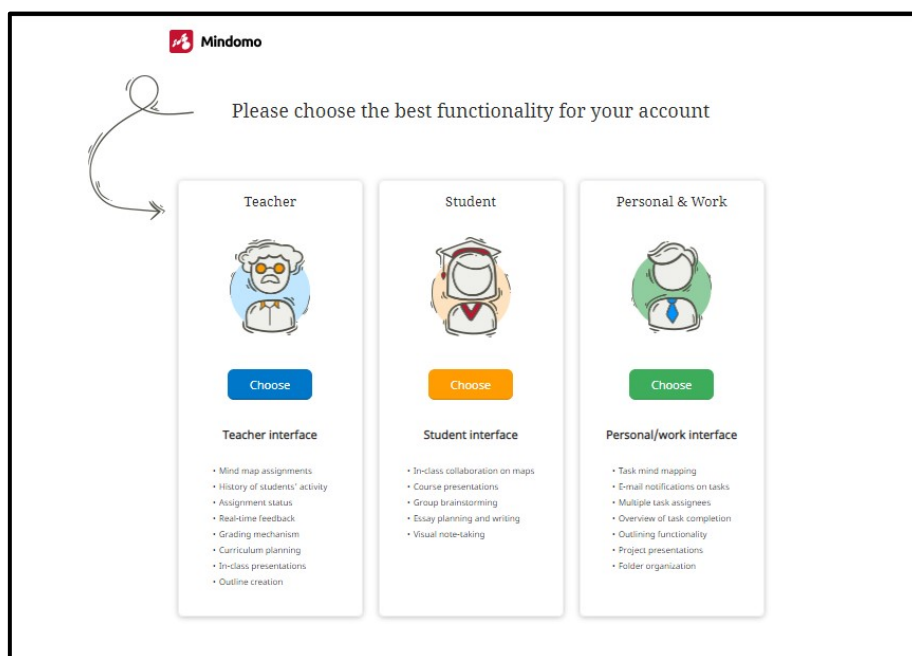
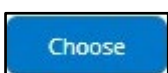
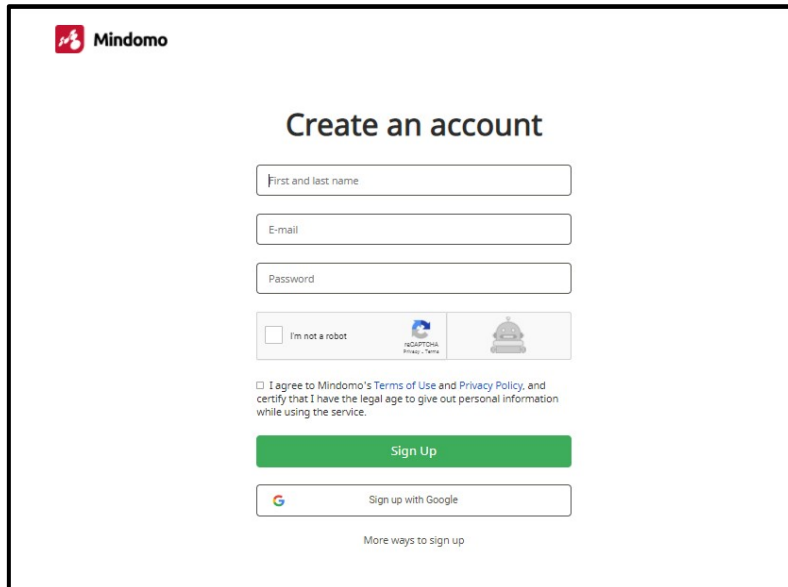



Figure 2

Select  under Teacher to create an account as a teacher. A page will appear as shown in Figure 3.



The image shows the 'Create an account' page for Mindomo. It features a form with the following elements: a 'First and last name' input field, an 'E-mail' input field, a 'Password' input field, a checkbox for 'I'm not a robot' with a CAPTCHA icon, and a checkbox for 'I agree to Mindomo's Terms of Use and Privacy Policy, and certify that I have the legal age to give out personal information while using the service.' Below the form is a green 'Sign Up' button and a 'Sign up with Google' button. At the bottom, there is a link for 'More ways to sign up'.

Figure 3

Fill in the details in the blanks provided and click on  or Click on  to create an account using a Google Id.

o **Dashboard**

After logging in, the dashboard page will appear as shown in Figure 4.

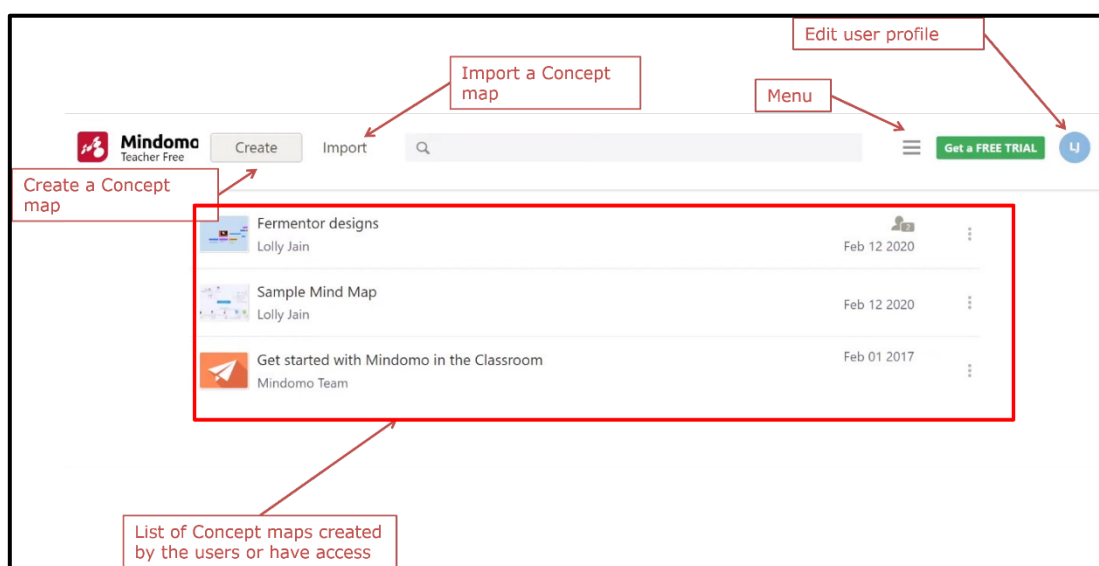

The screenshot shows the Mindomo dashboard. At the top, there is a navigation bar with 'Mindomo Teacher Free', 'Create', 'Import', a search bar, a 'Menu' icon, a 'Get a FREE TRIAL' button, and a user profile icon 'LJ'. Below the navigation bar, there is a list of concept maps. A red box highlights the list, and a red arrow points to it with the text 'List of Concept maps created by the users or have access'. Another red arrow points to the 'Create' button with the text 'Create a Concept map'. A third red arrow points to the 'Import' button with the text 'Import a Concept map'. A fourth red arrow points to the user profile icon with the text 'Edit user profile'.

Concept Map Title	Created By	Created Date
Fermentor designs	Lolly Jain	Feb 12 2020
Sample Mind Map	Lolly Jain	Feb 12 2020
Get started with Mindomo in the Classroom	Mindomo Team	Feb 01 2017

Figure 4

The dashboard gives the users the following options to use Mindomo for creating Concept Map.

- Create button allows the users to create a new Concept map
- Import options allows the user to import different types of files (shown in Figure 5) in Mindomo to create/edit/view.

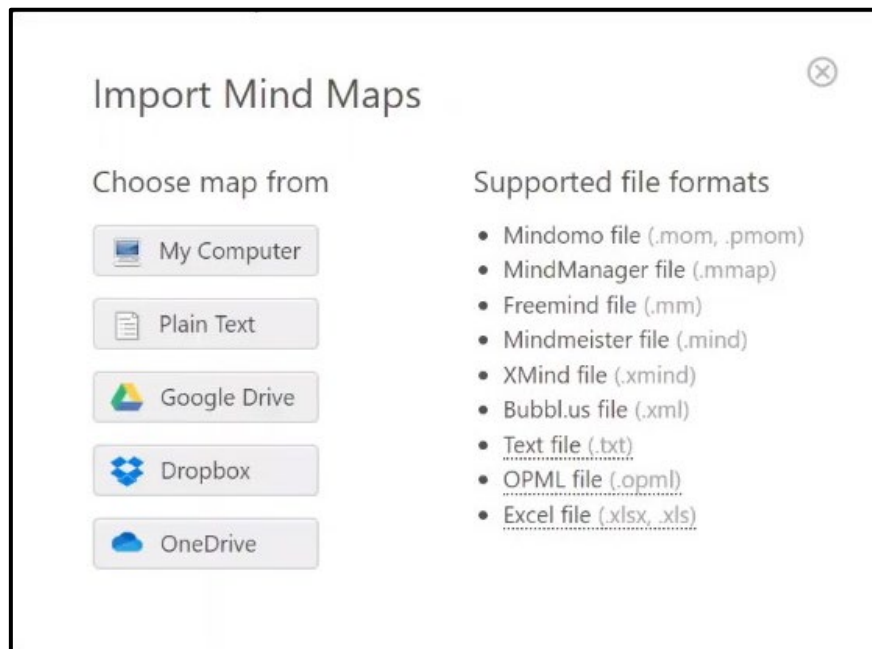

**Figure 5**

- Menu allows the user to navigate in the tool
- List of Concept Maps allows the user to view the maps which the user have created or have access to using sharing options. It displays the name of the map, the owner, date the map was created and if they are shared with



others using icon (the number displays the count of users that have access to the map).